

GREEN BUILDING Award

Fifth Town Artisan Cheese Company

Lapointe Architects

ARCHITECT
Lapointe Architects
Toronto, ON

CLIENT
Fifth Town Artisan Cheese Company
Prince Edward County, ON

STRUCTURAL ENGINEER
Blackwell Bowick Partnership Ltd.
Toronto, ON

GENERAL CONTRACTOR
K. Knudsen Construction Ltd.
Belleville, ON





Located in Prince Edward County, one of Ontario's fastest growing agri-tourism regions, the Fifth Town Artisan Cheese Company is a niche producer of fine hand-made goat and sheep milk cheeses.



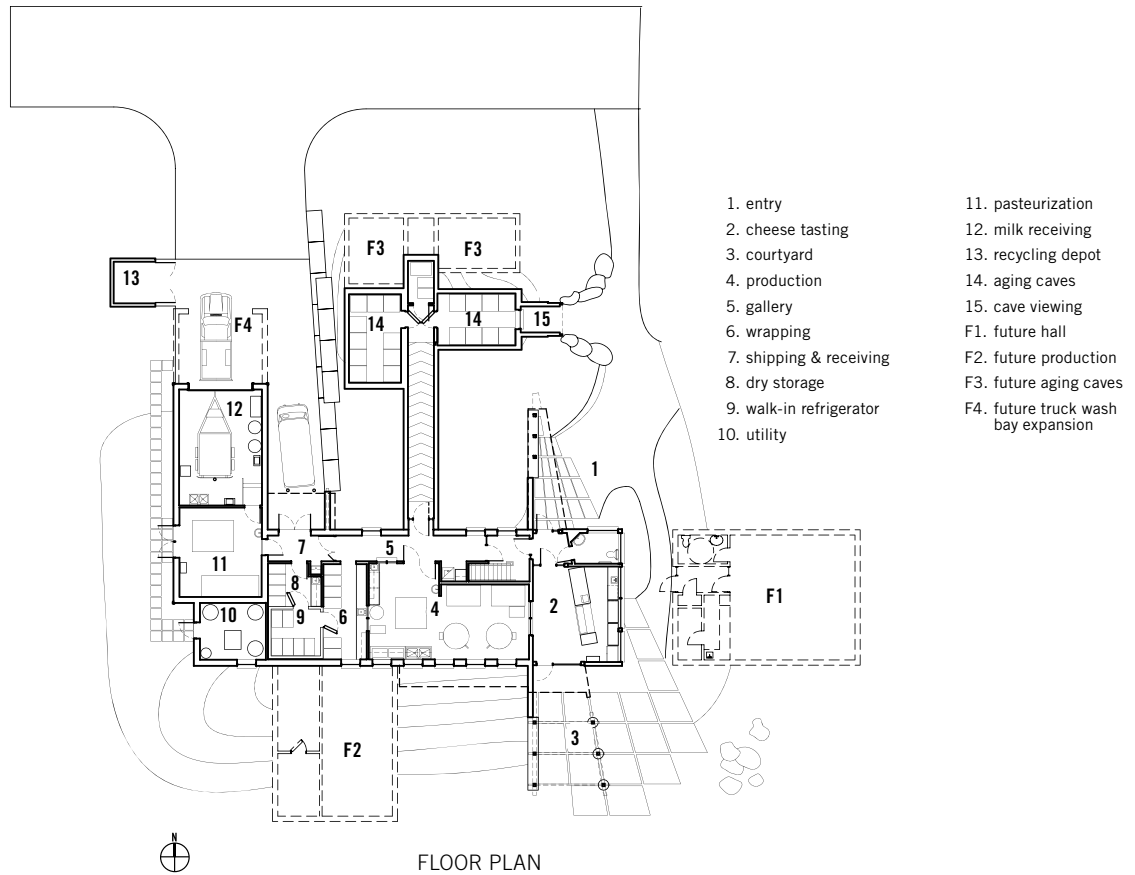

This overwhelmingly green project is located on a 20-acre site on the shores of Lake Ontario and is built on a rise overlooking a small creek and pond. Developed through close collaboration between the company's founder and the architect, the building, like the product manufactured there, is

characterized by quality and harmony with the environment. The building is North America's first LEED Platinum industrial building.

From the outset, the challenge was to make a significantly green building while experimenting with form and function to design a unique cheese fac-

tory. The decision to use wood from the ground up was made for a number of reasons.

As a structural system, Durisol (a stay-in-place wall form made of waste wood and concrete) was used for its extreme resistance to mold & mildew (a major concern in the moist



environment of a production area), its strength and durability, and its high R-value.

Engineered lumber and reclaimed barn beams were used for areas where the environmental concerns were less demanding. Wood was used to reinforce the vernacular architecture, as well as to add warmth to the build-

ing – something that is often lacking in a factory.

The use of all three states of wood was also very advantageous in achieving green certification – the recycled content of the Durisol blocks, the FSC content of the wood framing (totaling 55 per cent of all wood in the building), and the local barn beams, all

added to the project's environmental sustainability. Finally the reduced cost of wood, the local tradespeople's familiarity with it, its flexibility and light weight, all combined to ensure that wood was the appropriate building materials for this sustainable project even in the hot and humid environment of a cheese factory.

